

The background is a soft-focus image of a lake. The water is a deep, clear blue. Several green lily pads are scattered across the surface, some in the top left, top right, and bottom corners. Two bright yellow water lilies are in bloom, one positioned above the text and one below it. The text 'Lakeview' is centered in a clean, white, sans-serif font. Below the text, there is a faint, semi-transparent reflection of the word in a light blue color.

Lakeview

Premium luxury apartments in a serene setting



ARTIST'S IMPRESSION

At Brigade Lakeview, each 3- and 4-bedroom apartment has been designed as a spacious modern home, in a pleasant setting.

With just 3 apartments to a floor, each apartment will also afford plenty of privacy.

In addition, you will enjoy the benefits of large open spaces in your new home—all first floor apartments will open out into private gardens, while duplex apartments will feature large private terraces. The second, third, fourth, fifth and sixth floors, will have sizeable balconies.

Amenities include a gymnasium, party area and landscaped garden areas.

With all of this and more, your new home will open up a whole new world to you and your family. One that will enable you to lead a better quality of life in every way!

Site Plan & First Floor Layout

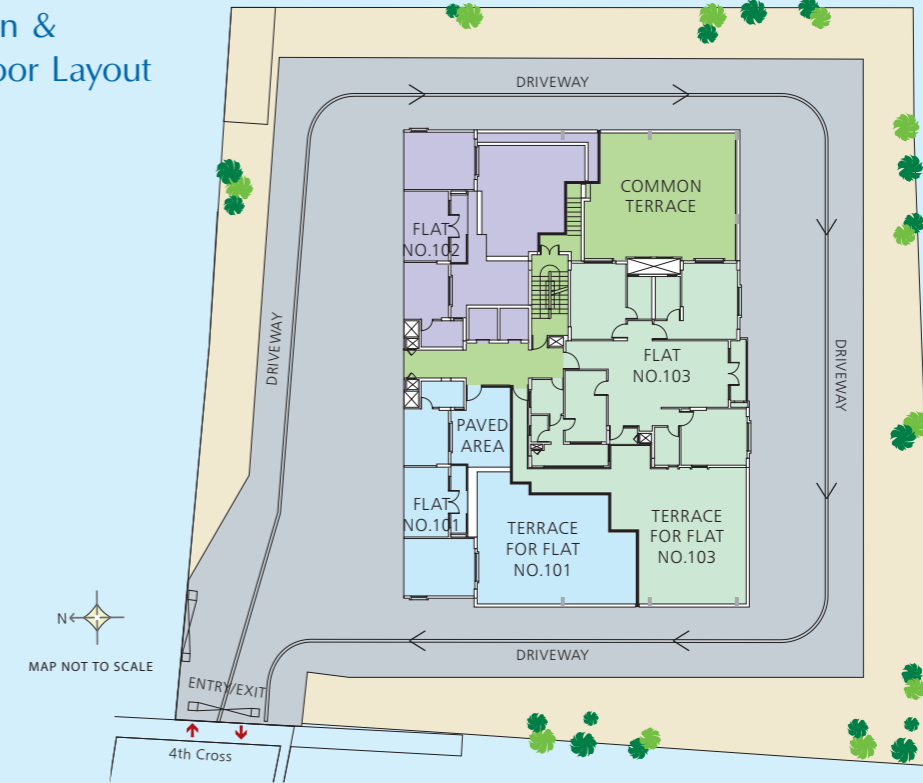

Area statement

Apt No.	Apt Area	Private Garden
101	2250 sft	+ 1050 sft
102	2250 sft	+ 750 sft
103	2140 sft	+ 1000 sft
201, 301, 401, 501, 601	2320 sft	
202, 302, 402, 502, 602	2320 sft	
203, 303, 403, 503, 603	2220 sft	
701, 702 (both duplex)	3380 sft	+ 920 sft
703 (duplex)	2940 sft	+ 1120 sft

Note: Ground floor is exclusively meant for stilt car parking lots.

3-Bedroom

2250 sft + 1050 sft
First Floor (101)



Site Plan



3-Bedroom

2140 sft + 1000 sft private garden
First Floor (103)



Site Plan

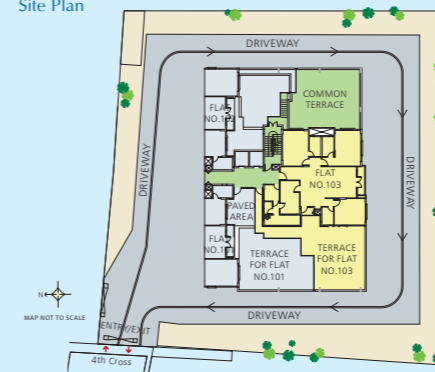

3-Bedroom

2320 sft—Typical Plan
Second to Sixth Floor

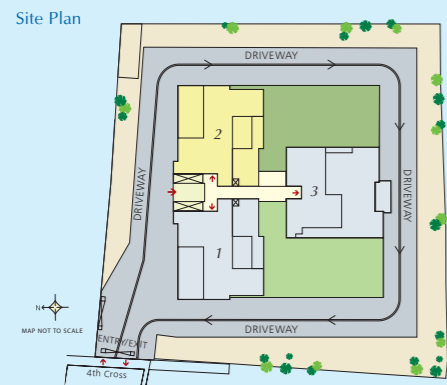

3-Bedroom

2220 sft—Typical Plan
Second to Sixth Floor

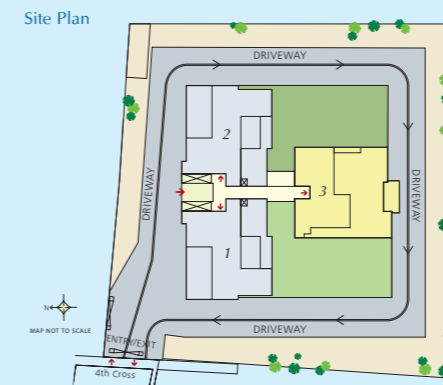

4-Bedroom Duplex

3129 sft + 921 sft Terrace
Seventh Floor (701)



4-Bedroom Duplex

2813 sft + 1118 sft Terrace
Seventh Floor (703)



Specifications, features & facilities

- **Doors**
Main Entrance: teakwood frame with thick teakwood panel shutter
Apt Entrance: teakwood frame with designer door shutter
Bedroom: sal or equivalent wood frame with painted 35mm-thick flush designer door shutter
Maid's room & toilet: sal or equivalent wood frame with resin-coated shutter
Balconies: UPVC
- **Windows**
UPVC windows with sliding shutters and mosquito mesh with safety grills
- **Common area flooring**
Lobbies and corridors: green marble on all floors
Staircase: granite slab for ground floor and green marble slab on upper floors
- **Apt flooring**
Vitrified tiles: living / dining / foyer / bedrooms / kitchen
Non-skid ceramic tiles: balcony / maid's room / toilets
Glazed ceramic tiles dado: above the platform in the kitchen
- **Kitchen**
Black granite counter with 1½ bowl stainless steel sink and drain board
- Premium quality sanitary and plumbing fixtures. Bath tub in master bedroom toilet
- **Painting**
Exterior: long lasting texture paint
Interior: walls with plastic emulsion & ceiling with oil bound distemper
- **Power supply for each apartment**
KPTCL / BESCO power: 3-bedroom apts (8 kW) and 4-bedroom apts (10kW)
Stand-by power: 3-bedroom apts (2 kW), 4-bedroom apts (3 kW), lifts, pumps and common area lighting
- 2 passenger lifts of 10-passenger capacity each
- Fire protection system as per the Karnataka Fire Force standard
- Parking at ground level on ownership basis only
- Landscaped garden
- Open party area
- Gymnasium

A convenient and strategic location

Brigade Lakeview is situated at BTM Layout, close to the Madivala lake. It is just 1 kilometre from the Silk Board Junction flyover. The Ring Road and Electronic City are easily accessible. Major shopping destinations, educational institutions and medical facilities are also close by.





Brigade Lakeview, 4th Cross, 35th Main, BTM 2nd Stage, Bangalore 560 068
sms: **Brigade Lakeview to 56767**

Corp. offices: Brigade Enterprises Limited, Hulkul Brigade Centre, 82, Lavelle Road (next to B'lore Club), Bangalore 560 001
Ph: **+91-80-4137 9200, 98804 05234 / 47** Fax: **+91-80-4137 9320** enquiry@brigadegroup.com **brigadegroup.com**

FOR A BETTER QUALITY OF LIFE, UPGRADE TO BRIGADE