

# UNIT PLAN - CIELO AT BRIGADE VALENCIA

## 1 BHK 1T-TYPE 1B

C 0024 - C 2224

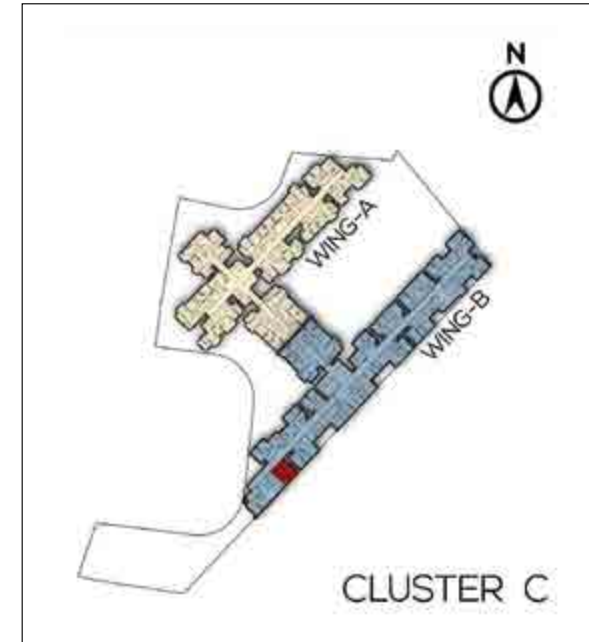

**SUPER BUILT-UP AREA**  
54.40 Sq.m / 586 Sq.ft

**UNIT CARPET AREA**  
31.77 Sq.m / 342 Sq.ft

**BALCONY AREA**  
2.42 Sq.m / 26 Sq.ft

The information depicted herein viz., master plans, floor plans, furniture layout, fittings, illustrations, specifications, designs, dimensions, rendered views, colours, amenities and facilities etc., are subject to change without notifications as may be required by the relevant authorities or the Developer's architect, and cannot form part of an offer or contract. Whilst every care is taken in providing this information, the Developer cannot be held liable for variations. All illustrations and pictures are artist's impressions only. The information is subject to variations, additions, deletions, substitutions and modifications as may be recommended by the company's architect and/or the relevant approving authorities. The Developer is wholly exempt from any liability on account of any claim in this regard. (1 square metre = 10.764 square feet). E & OE. All dimensions and calculations are done in metric system (M/Sq.m), and imperial system (Ft/Sq.ft) shown is for reference only. All dimensions indicated in the drawing are from unfinished surfaces, excluding plaster thickness and tile thickness.

# UNIT PLAN - CIELO AT BRIGADE VALENCIA

## 2 BHK 2T-TYPE 3

C 0007 - 2207

C 0026 - 2226

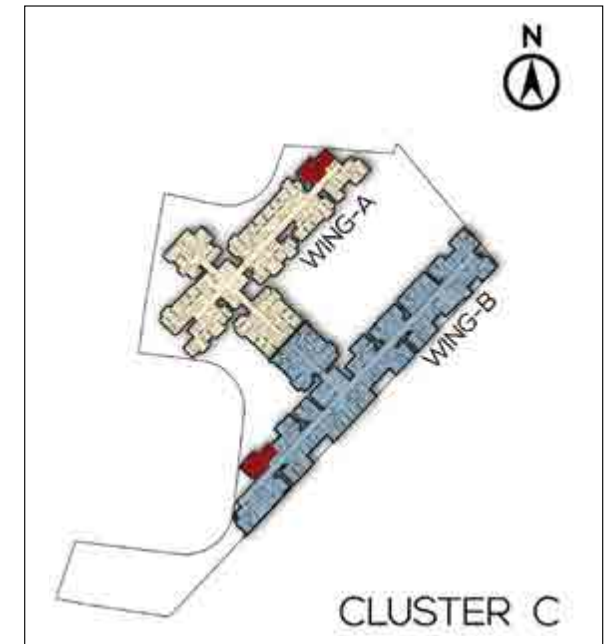

**SUPER BUILT-UP AREA**  
89.7 Sq.m / 966 Sq.ft

**UNIT CARPET AREA**  
54.19 Sq.m / 583 Sq.ft

**BALCONY AREA**  
2.68 Sq.m / 29 Sq.ft

The information depicted herein viz., master plans, floor plans, furniture layout, fittings, illustrations, specifications, designs, dimensions, rendered views, colours, amenities and facilities etc., are subject to change without notifications as may be required by the relevant authorities or the Developer's architect, and cannot form part of an offer or contract. Whilst every care is taken in providing this information, the Developer cannot be held liable for variations. All illustrations and pictures are artist's impressions only. The information is subject to variations, additions, deletions, substitutions and modifications as may be recommended by the company's architect and/or the relevant approving authorities. The Developer is wholly exempt from any liability on account of any claim in this regard. (1 square metre = 10.764 square feet). E & OE. All dimensions and calculations are done in metric system (M/Sq.m), and imperial system (Ft/Sq.ft) shown is for reference only. All dimensions indicated in the drawing are from unfinished surfaces, excluding plaster thickness and tile thickness.

# UNIT PLAN - CIELO AT BRIGADE VALENCIA

## 2 BHK 2T STUDY-TYPE 1

C 0014 - 2214

C 0115 - 2215

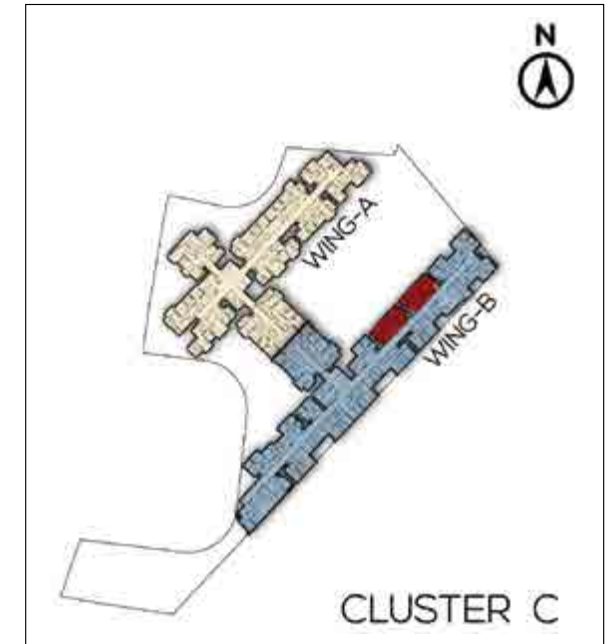

**SUPER BUILT-UP AREA**  
106.69 Sq.m / 1148 Sq.ft

**UNIT CARPET AREA**  
62.98 Sq.m / 678 Sq.ft

**BALCONY AREA**  
5.00 Sq.m / 54 Sq.ft

The information depicted herein viz., master plans, floor plans, furniture layout, fittings, illustrations, specifications, designs, dimensions, rendered views, colours, amenities and facilities etc., are subject to change without notifications as may be required by the relevant authorities or the Developer's architect, and cannot form part of an offer or contract. Whilst every care is taken in providing this information, the Developer cannot be held liable for variations. All illustrations and pictures are artist's impressions only. The information is subject to variations, additions, deletions, substitutions and modifications as may be recommended by the company's architect and/or the relevant approving authorities. The Developer is wholly exempt from any liability on account of any claim in this regard. (1 square metre = 10.764 square feet). E & OE. All dimensions and calculations are done in metric system (M/Sq.m), and imperial system (Ft/Sq.ft) shown is for reference only. All dimensions indicated in the drawing are from unfinished surfaces, excluding plaster thickness and tile thickness.

# UNIT PLAN - CIELO AT BRIGADE VALENCIA

## 2 BHK 2T STUDY-TYPE 2A

C 0019 - 2219

C 0021 - 2221

C 0023 - 2223

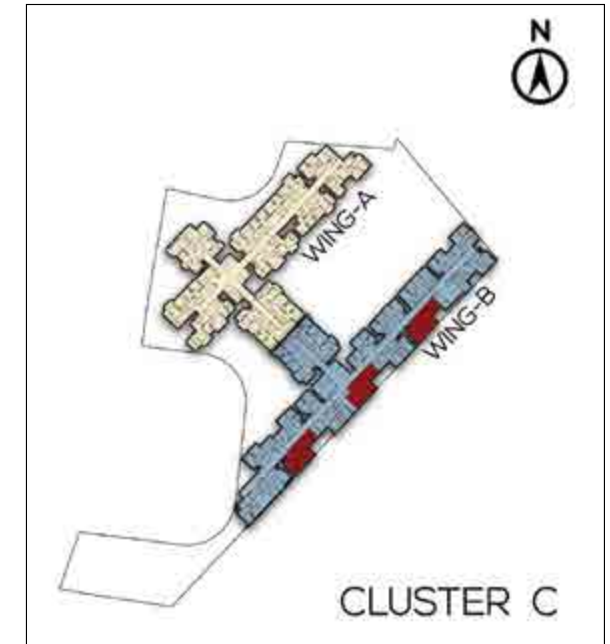

**SUPER BUILT-UP AREA**  
111.59 Sq.m / 1201 Sq.ft

**UNIT CARPET AREA**  
68.96 Sq.m / 742 Sq.ft

**BALCONY AREA**  
2.8 Sq.m / 30 Sq.ft

The information depicted herein viz., master plans, floor plans, furniture layout, fittings, illustrations, specifications, designs, dimensions, rendered views, colours, amenities and facilities etc., are subject to change without notifications as may be required by the relevant authorities or the Developer's architect, and cannot form part of an offer or contract. Whilst every care is taken in providing this information, the Developer cannot be held liable for variations. All illustrations and pictures are artist's impressions only. The information is subject to variations, additions, deletions, substitutions and modifications as may be recommended by the company's architect and/or the relevant approving authorities. The Developer is wholly exempt from any liability on account of any claim in this regard. (1 square metre = 10.764 square feet). E & OE. All dimensions and calculations are done in metric system (M/Sq.m), and imperial system (Ft/Sq.ft) shown is for reference only. All dimensions indicated in the drawing are from unfinished surfaces, excluding plaster thickness and tile thickness.

# UNIT PLAN - CIELO AT BRIGADE VALENCIA

## 3 BHK 2T-TYPE 1B

C 0001 - 2201

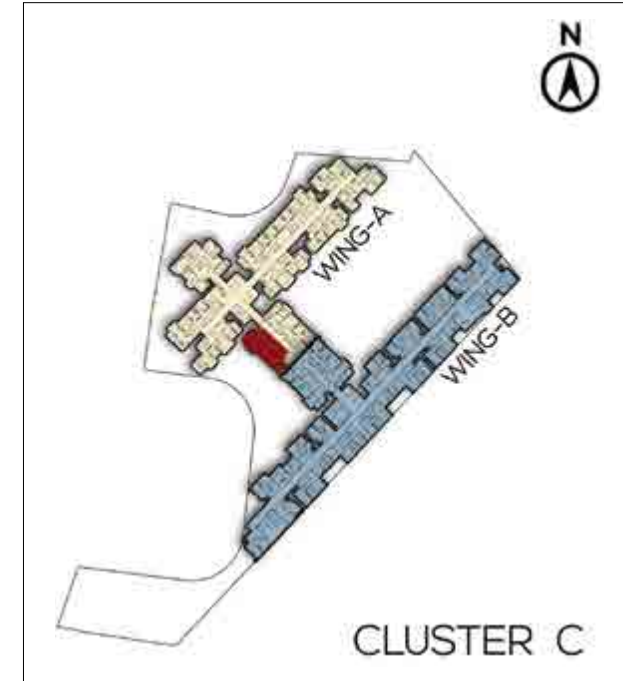

**SUPER BUILT-UP AREA**  
136.96 Sq.m / 1474 Sq.ft

**UNIT CARPET AREA**  
81.75 Sq.m / 880 Sq.ft

**BALCONY AREA**  
6.12 Sq.m / 66 Sq.ft

The information depicted herein viz., master plans, floor plans, furniture layout, fittings, illustrations, specifications, designs, dimensions, rendered views, colours, amenities and facilities etc., are subject to change without notifications as may be required by the relevant authorities or the Developer's architect, and cannot form part of an offer or contract. Whilst every care is taken in providing this information, the Developer cannot be held liable for variations. All illustrations and pictures are artist's impressions only. The information is subject to variations, additions, deletions, substitutions and modifications as may be recommended by the company's architect and/or the relevant approving authorities. The Developer is wholly exempt from any liability on account of any claim in this regard. (1 square metre = 10.764 square feet). E & OE. All dimensions and calculations are done in metric system (M/Sq.m), and imperial system (Ft/Sq.ft) shown is for reference only. All dimensions indicated in the drawing are from unfinished surfaces, excluding plaster thickness and tile thickness.

# UNIT PLAN - CIELO AT BRIGADE VALENCIA

## 3 BHK 3T-TYPE 1A

C 0010 - 2210

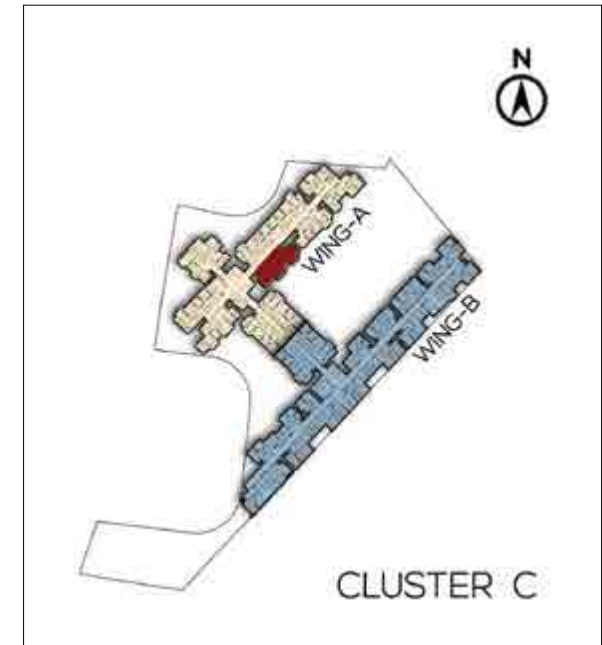

**SUPER BUILT-UP AREA**

155.86 Sq.m / 1678 Sq.ft

**UNIT CARPET AREA**

92.22 Sq.m / 993 Sq.ft

**BALCONY AREA**

7.79 Sq.m / 84 Sq.ft

The information depicted herein viz., master plans, floor plans, furniture layout, fittings, illustrations, specifications, designs, dimensions, rendered views, colours, amenities and facilities etc., are subject to change without notifications as may be required by the relevant authorities or the Developer's architect, and cannot form part of an offer or contract. Whilst every care is taken in providing this information, the Developer cannot be held liable for variations. All illustrations and pictures are artist's impressions only. The information is subject to variations, additions, deletions, substitutions and modifications as may be recommended by the company's architect and/or the relevant approving authorities. The Developer is wholly exempt from any liability on account of any claim in this regard. (1 square metre = 10.764 square feet). E & OE. All dimensions and calculations are done in metric system (M/Sq.m), and imperial system (Ft/Sq.ft) shown is for reference only. All dimensions indicated in the drawing are from unfinished surfaces, excluding plaster thickness and tile thickness.

# UNIT PLAN - CIELO AT BRIGADE VALENCIA

## 4 BHK 3T + MAID ROOM

C 0004 - 2204

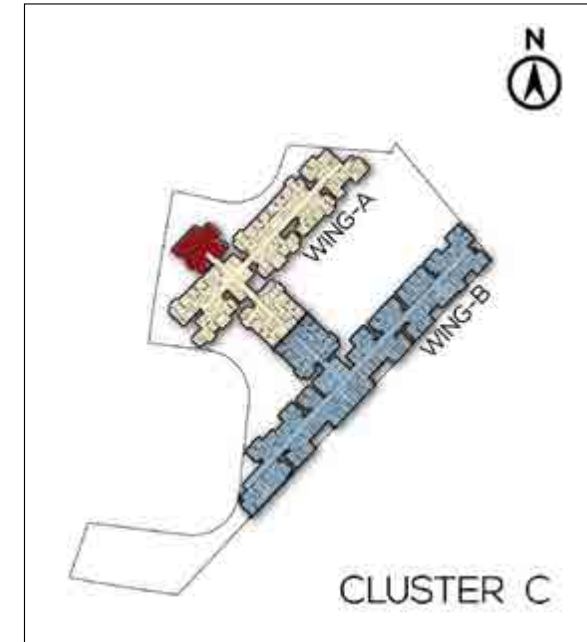

**SUPER BUILT-UP AREA**  
211.47 Sq.m / 2276 Sq.ft

**UNIT CARPET AREA**  
130.28 Sq.m / 1,402 Sq.ft

**BALCONY AREA**  
6.94 Sq.m / 75 Sq.ft

The information depicted herein viz., master plans, floor plans, furniture layout, fittings, illustrations, specifications, designs, dimensions, rendered views, colours, amenities and facilities etc., are subject to change without notifications as may be required by the relevant authorities or the Developer's architect, and cannot form part of an offer or contract. Whilst every care is taken in providing this information, the Developer cannot be held liable for variations. All illustrations and pictures are artist's impressions only. The information is subject to variations, additions, deletions, substitutions and modifications as may be recommended by the company's architect and/or the relevant approving authorities. The Developer is wholly exempt from any liability on account of any claim in this regard. (1 square metre = 10.764 square feet). E & OE. All dimensions and calculations are done in metric system (M/Sq.m), and imperial system (Ft/Sq.ft) shown is for reference only. All dimensions indicated in the drawing are from unfinished surfaces, excluding plaster thickness and tile thickness.